

Drilling spindle ER25

Direct drive / belt drive



Application:

Our drilling spindles are used for drilling wood, plastic and metal.

Design:

The drilling spindle is equipped with an ER 25 chuck holder as standard, the spindle length is determined by the specifications of the customer or available in a standard length.

The ER25drill spindle is available both as a direct-drive unit and with a belt drive.

Custom design:

If desired, we would be happy to create a custom design for you.

Drilling spindle – Direct drive with chuck holder ER 25

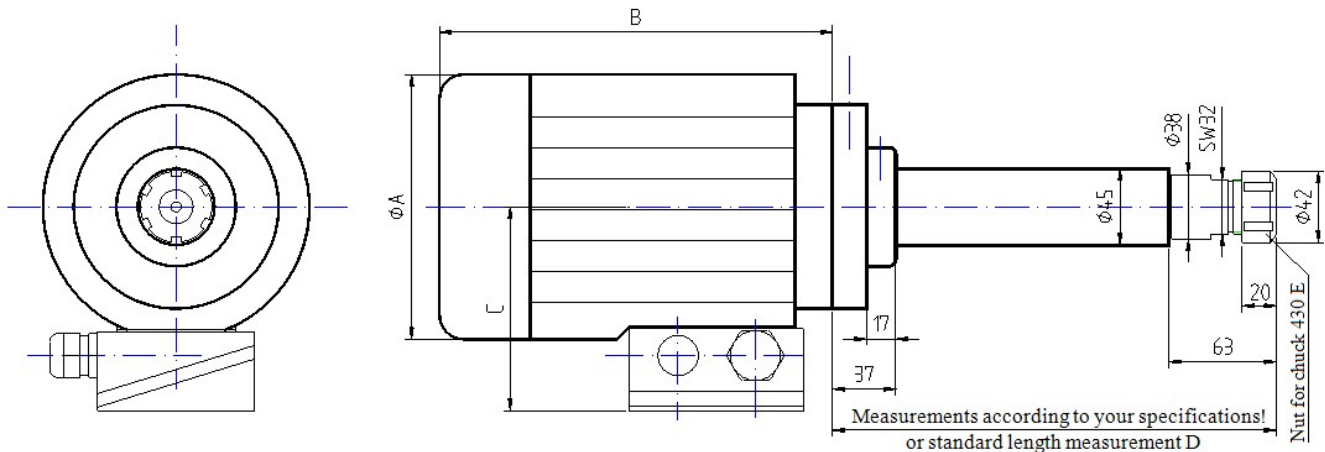

Motor	A	B	C	Motor power
Size 80	160	245	120	0,55 – 1,1 kW
Size 90	195	270	137	1,1 – 2,2 kW

Technical data:

Standard lengths

dimension D: 340, 372 und 440 mm

Spindle speed: same as motor speed 750 - 980 - 1400 - 2800 Rpm
with a frequency converter, a speed up to 6000 Rpm is possible.
A cooling ring is required for continuous operation over 5000 Rpm.
The motor speed depends on the motor size and the respective motor power.

Please always inquire about motor power and speed separately!

Drive: Three-phase motor direct

Tool holder: UNF 1/2"-20 threads for drill chuck, Multi-spindle drilling heads und chuck holder ER25.

Assembly: on diameter 45f7 through clamping flange
(however not included in the scope of supply)

Run-out accuracy: 0,05 mm on the tool

Max. Drilling capacity: Ø 14 mm, in St 50

Drilling spindles – belt drive with chuck holder ER 25

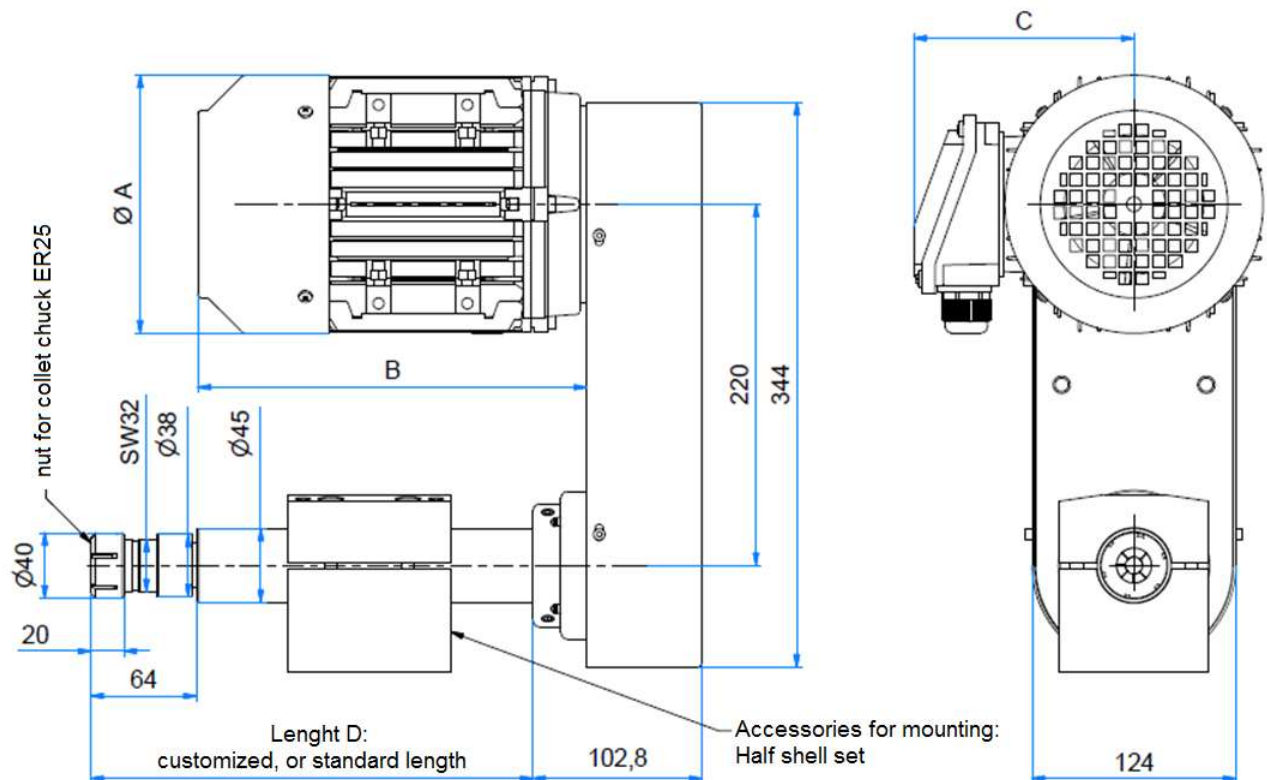

Motor	A	B	C	Motor power
Size 80	160	245	120	0,55 – 1,1 kW
Size 90	195	270	137	1,1 – 2,2 kW

Technical data:

Standard lengths dimension D: 282, 427 and 467 mm

Spindle speed: between 300 and 8000 Rpm depending on motor speed.
A cooling ring is required for continuous operation over 5000 Rpm.

Drive: three-phase motor with V-ribbed belt.

Tool holder: UNF 1/2"-20 threads for drill chuck, Multi-spindle drilling-heads und chuck holder ER25.

Assembly: on diameter 45f7 through clamping flange
(however not included in the scope of supply)

Run-out accuracy: 0,05 mm on the tool

Max. drilling capacity: Ø 16 mm, in St 50

Customized - drilling spindles

Drilling spindle ER16 belt drive Produkt no. 630182

Spindle with tool holder ER16
with spring-loaded drilling guide
for ISO standard motors size 71
only high-speed gear ratios are suitable



Drilling spindle belt drive Produkt no. 02 04 03 2100 Incl. adjustable drill dead V-MSK 7-2

The spindle holder is design as a conveyer. The adjustable two-spindle drill head V-MSK 7-2 is adapt over a clamping flange and has additionally a spring-loaded drill guide plate for ISO standard motors size 71 only high-speed gear ratios are suitable

